

BEFORE ASSEMBLING YOUR ATV MOUNT
FOLLOW INSTRUCTIONS IN YOUR SPOT
SPRAYER ASSEMBLY MANUAL

INCLUDED COMPONENTS

HAVING TROUBLE? CALL SUPPORT AT: 800.825.5397

TOOLS REQUIRED



1/2" SOCKET WRENCH

NOTE:
ONCE YOU HAVE FINISHED THE SPOT SPRAYER AND
ATV MOUNT ASSEMBLY, MOVE ON TO THE BOOM ASSEMBLY
CARD TO COMPLETE YOUR SPRAYER.

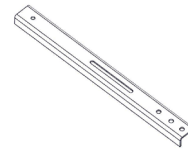

ATV Mounts (2)
31-100288

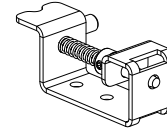

Spring Bracket Mounts (2)
34-140168



Ratchet Straps (2)
33-100164

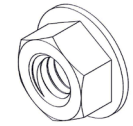

Flange Nuts (4)
33-100113

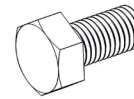

1/2" Bolts (4)
33-100114

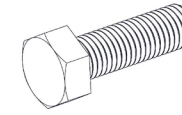

3/4" Bolts (4)
33-200120



Washers (4)
33-100115

1.

PARTS

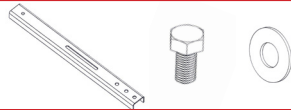

TOOLS

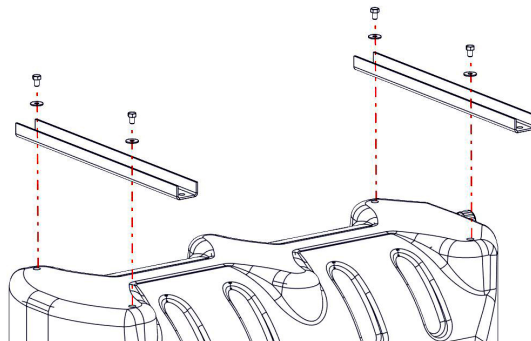

NOTE: Make sure to have the
ends of the ATV Mounts that
feature multiple holes on
the same side as the Pump
head.

Attaches ATV Mounts to Sprayer Tank

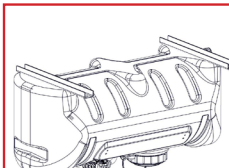

Flip your Sprayer Tank over to access the holes on the bottom.

Position ATV Mounts over Sprayer Tank holes.

Attach ATV Mounts to Sprayer Tank with 1/2" Bolts and Washers
using a Socket Wrench. Do not over tighten.

2.

PARTS



TOOLS

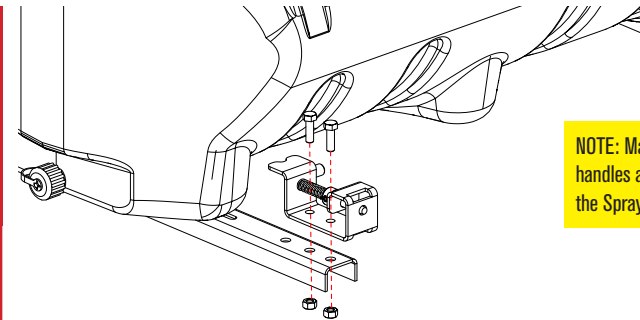

NOTE: Make sure spring
handles are facing towards
the Sprayer Tank.

Attaches Spring Bracket Mounts to
ATV Mounts

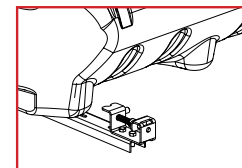

Set the Sprayer Tank upright.

Position Spring Bracket Mounts on the last two holes of the
ATV Mounts.

Attach Spring Brackets with 3/4" Bolts and Flange Nuts and
tighten with Socket Wrench.

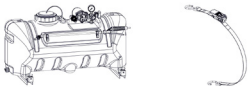
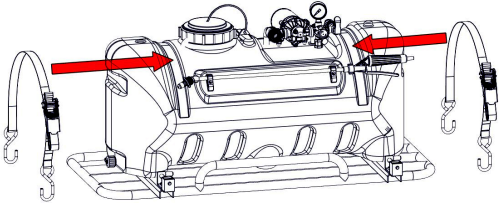
3.	PARTS	
TOOLS	 <p data-bbox="867 407 1063 488">NOTE: If not done already, assemble your Boom Kit after completing this step.</p>	
None	<p data-bbox="194 672 833 732">Position Sprayer Tank onto the back of an ATV, ensure that Spring Bracket Mounts hang over the back end.</p> <p data-bbox="194 764 842 824">Use Ratchet Straps within the vertical grooves on the Sprayer Tank to fasten Sprayer Tank securely to the ATV rack.</p>	

Installs Sprayer on ATV Rack

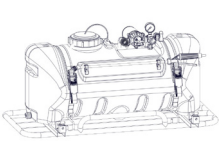

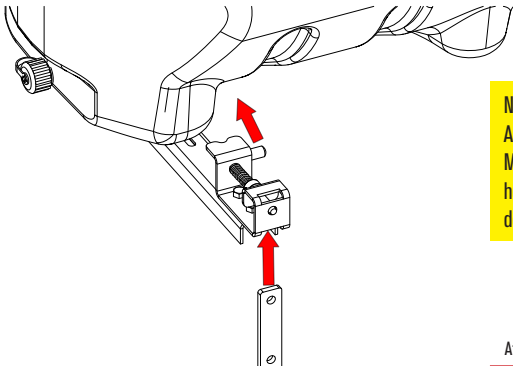
4.	PARTS	
TOOLS	 <p data-bbox="1860 386 2057 521">NOTE: Depending on Boom Assembly installation, ATV Mounts can help adjust height of Boom Assembly depending on application.</p>	
None	<p data-bbox="1201 672 1676 699">Pull back spring handle of Spring Bracket Mount.</p> <p data-bbox="1201 732 1793 792">Insert a Boom Upright Bracket into the Spring Bracket Mount and line up holes of each part.</p> <p data-bbox="1201 824 1811 852">Release spring handle to lock Boom Upright Bracket into place.</p>	

Attaches Boom Assembly to Sprayer

