

180 Lake Ave North  
Paynesville, MN 56362  
Phone: 320-340-6464  
www.master-mfg.com



**MASTER  
MANUFACTURING**

**40/60 GALLON FLEX FRAME HOSE REEL**



Part Number SFFK-4060HR1-MM | Rev 2 July 2018

**Note: Do not return product to the distributor/dealer for warranty work.  
Call Master Manufacturing at 320-340-6464 for any warranty work or replacement parts.**

### **INTRODUCTION**

Your Master Manufacturing Flex Frame Hose Reel has been manufactured to provide years of dependable and efficient use. Proper operation and maintenance will ensure long satisfactory service. The purpose of this manual is to assist you in the assembly, operation and maintenance of your sprayer or accessories. Please read through this manual completely to fully understand how to operate and maintain your equipment. Keep your manual in a safe, convenient place for future reference. Always mention the model and part number in any correspondence.

### **Warnings**

- △ Tank and skid frame must be securely fastened to vehicle to ensure proper handling. Failure to fasten tank securely to vehicle may lead to injury.**
- △ Tank total weight filled with liquid must not exceed manufactures weight limit for vehicle. Refer to vehicle manufacture specifications**

### **TOOLS REQUIRED FOR ASSEMBLY**

The following tools are required to assemble the Flex Frame Hose Reel.

1/2" COMBINATION WRENCH



1/2" SOCKET WRENCH



## FLEX FRAME HOSE REEL

### **KIT CONTENTS**

**NOTE:** If you are missing any of the following hardware items, contact Master Manufacturing for replacements.

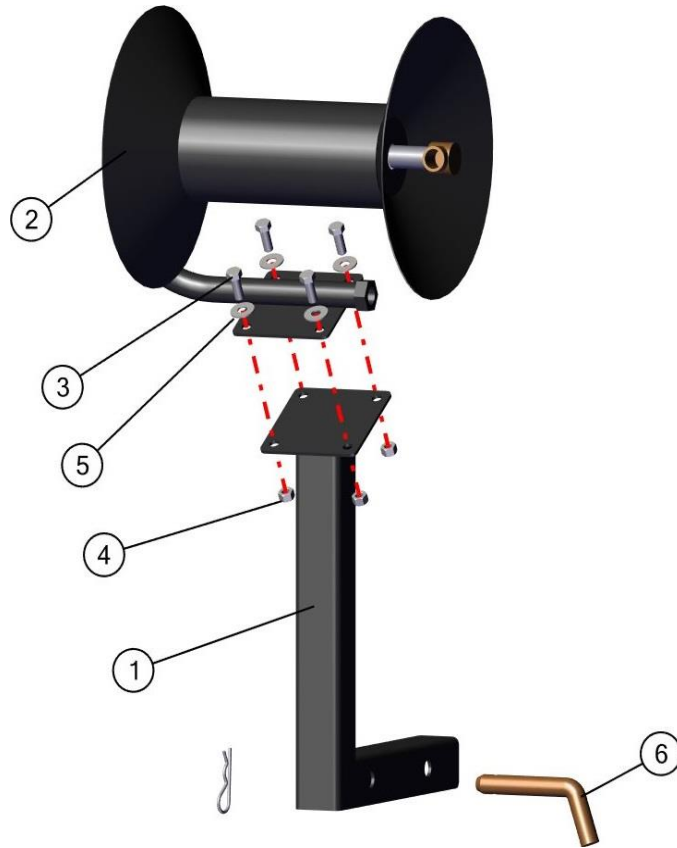

BOM ID	Qty	Part No	Description
1	1	32-100109	REEL MOUNT, FLEX FRAME
2	1	HR-75	REEL, HOSE, 75'
3	4	33-100116	BOLT, 5/16-18 X 1"
4	4	33-100113	NUT, 5/16-18, SERRATED FLANGE
5	4	33-100115	WASHER, 5/16, ZINC PLATED
6	1	722HP	BENT PIN 5/8" X 3" W/ COTTER PIN
7	1	33-103153	GATES 3/8" RUBBER HOSE (NOT SHOWN)
8	1	3EL38	ELBOW: 3/8" MPT X 3/8" HB POLY (NOT SHOWN)

## **ASSEMBLY INSTRUCTIONS**

The Hose Reel has been specifically designed to attach easily to the 40 and 60 Gallon Master Manufacturing Flex Frame. Please refer to the figures in this manual for reference to the following assembly instructions.

### **Step 1**

Detach the Spray Gun hose from the Pressure Regulator and set the Spray Gun aside.

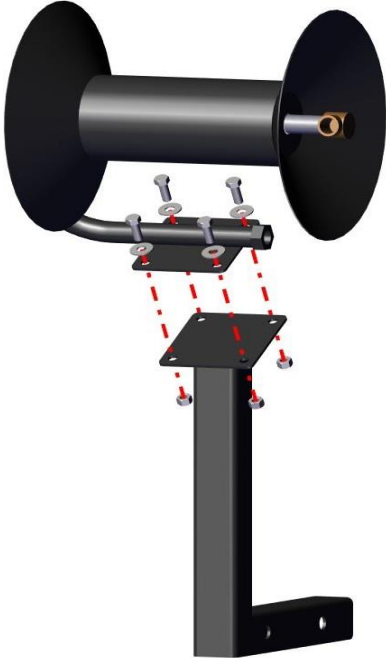

### **Step 2**

Assemble the Hose Reel per the included instructions. Attach the Hose Reel to the Reel Mount using the 5/16-18 bolts, washers, and nuts as shown.



### **Step 3**

Insert the Reel Mount into an open Receiver on the Flex Frame (Tank hidden for clarity) and secure with the Hitch Pin, then secure the Hitch Pin with the Cotter Pin.

## FLEX FRAME HOSE REEL

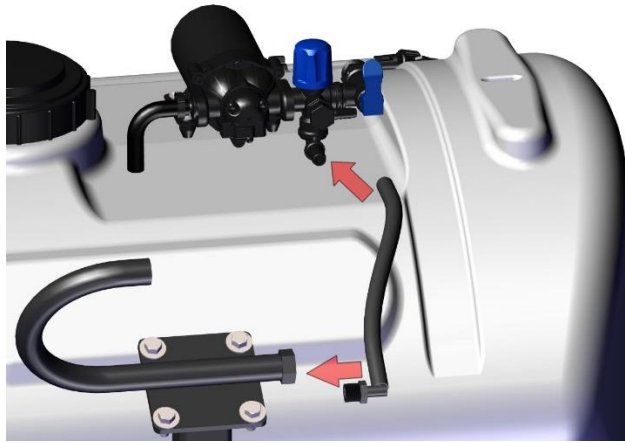

### Step 4

Connect the Elbow (3EL38) to the Hose Reel, making sure to use the included thread seal tape. Attach the Hose (33-103153) to the Elbow on the Reel and on the Pressure Regulator. Secure with the Hose Clips (SHC-f).

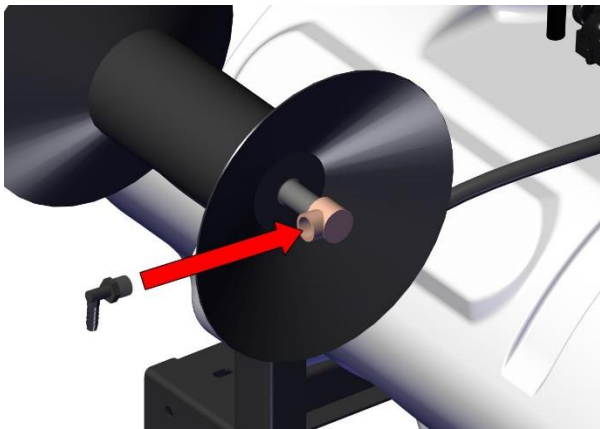

### Step 5

Attach the Elbow (3EL38) to the Hose Reel as shown.



### Step 6

Run the Spray Gun hose through the window in Hose Reel side and attach to the Elbow with a Hose Clip as shown. Wind the Hose Reel to wrap the Spray Gun hose, leaving enough loose hose to secure the Spray Gun in the Gun Clips on the Tank.

## WARRANTY PARTS SERVICE

Products sold shall be warranted from defects in workmanship and material when used within the service and scope for which they were designed for a period of one year from date of purchase. Warranty covers replacement parts ONLY. Contact Master Manufacturing for warranty parts at 320-340-6464. Do not return product to your distributor/dealer. Please have your original sales receipt or other proof of purchase date when requesting any warranty parts. To ensure the correct parts are acquired always provide the model number of your sprayer/attachment and the part number and description obtained from the illustrated parts breakdown in this manual.